

53015

Installation Instructions

A

1. Turn off water supply.
2. Remove old hose.
3. Slide ferrule nut(4) over hose end.
4. Insert clip(5) into groove on the hose end.
5. Place two washers(2, 3) onto spray head(1).
6. Screw ferrule nut(4) onto spray(1).

B-1

1. Screw quick connect adapter(1) into hose.
2. Insert adapter(2) into diverter clip.
3. While pulling back on white collar on quick connect adapter(Fig. a).
4. Push quick connect adapter(1) onto adapter(2).

B-2

1. Screw quick connect adapter(1) into hose.
2. While pulling back on white collar on quick connect adapter(Fig. a).
3. Push quick connect adapter(1) onto nipple.

B-3

1. Screw adapter(1) into hose.
2. Insert adapter(1) into diverter clip.

B-4

1. Screw adapter(1) into hose.
 2. Insert adapter(1) into diverter clip.
- Do not overtighten. Overtightening may cause damage.**

C

1. Turn on water supply.
2. Check for leaks.

A

1. Cierre el suministro de agua.
2. Remover la manguera.
3. Deslizar la tuerca ferula(4) sobre manguera.
4. Inserte clip en la ranura que esta al final de la manguera.
5. Poner arandelas(2,3) sobre la rociadora(4).
6. Atornillar la tuerca ferule(4) en la cabeza rociadora.

B-1

1. Atornillar el adaptador conector rapido (1) en la manguera.
2. Inserte el adaptador en el clip desviador.

B-2

1. Atornillar el adaptador conector rapido (1) en la manguera.

B-3

1. Atornillar el adaptador (1) en la manguera.
2. Inserte el adaptador en el clip desviador.

B-4

1. Atornillar el adaptador (1) en la manguera.
2. Inserte el adaptador en el clip desviador.

No apretario demasiado. Apretario demasiado puede causar dano.

C

1. Conecte el suministro de agua.
2. Revise que no hayan fugas.

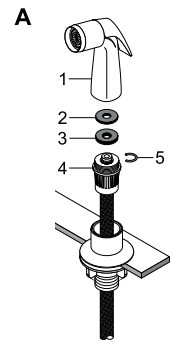
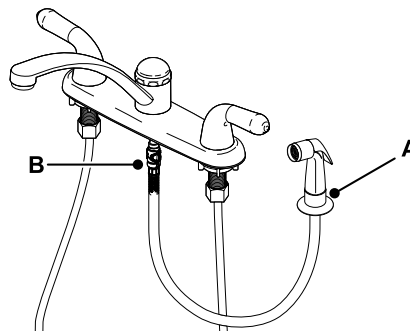

B-1

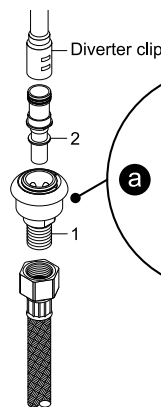

B-2

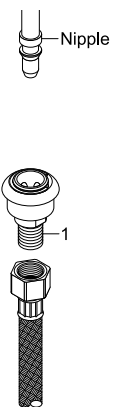

B-3

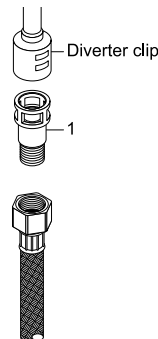

B-4

