

58207

Installation Instructions

1. Turn off water supply
2. Remove handle cap and retaining screw and remove handle by pulling straight out.
3. Remove old flange and tube by loosening set screw.
4. Install new flange and tube onto bonnet nut and tighten set screw.
5. Replace handle and tighten with retaining screw.
6. Replace handle cap and turn on water supply.

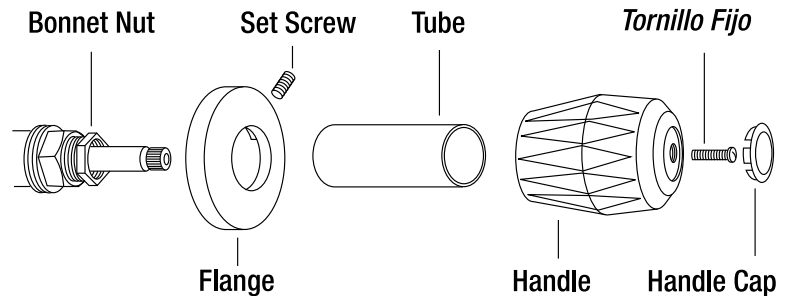

Tools needed for installation: • Adjustable Wrench • Screwdriver