

58395B

Installation Instructions

1. Turn off water supply.
2. Using included allen wrench, partly unthread set screw, and then pull off handle.
3. Unthread and remove cap assembly. Remove spout by pulling straight up.
4. Remove existing ball and cam by pulling up on ball stem.
5. Remove existing seats and springs.
6. Remove existing faucet o-rings, and install new o-rings.
7. Install new springs and seats.
8. Install new ball, then place new cam assembly (with rubber cam packing below plastic cam) on top of ball. Make sure that lug on side of cam is inserted into slot on the side of the faucet body.
9. Tighten cap assembly securely. Reassemble handle to faucet.
10. Turn on water and check for leaks.

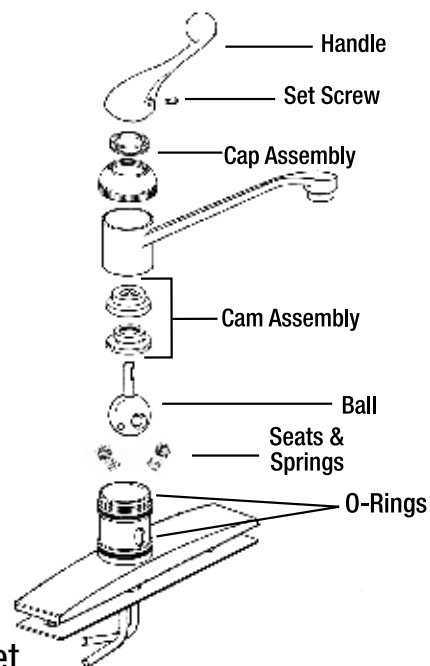

Tools needed for installation: • Adjustable Wrench