

58503

Installation Instructions

1. Remove Overflow Plate Screws.
2. Carefully remove Overflow Plate with Lever and entire linkage assembly.
3. Disconnect linkage assembly from back of worn Overflow Plate with Lever.
4. Connect linkage assembly to back of new Overflow Plate with Lever.
5. Carefully feed linkage assembly through hole in tub.
6. Align screw holes on new Overflow Plate with Lever and thread screws into place. Tighten with screwdriver.
7. Remove Bath Shoe using a bath shoe removal tool. Remove worn Tub Gasket.
8. Using a soft cloth, remove debris from inside drain threads and the lip of the tub.
9. For 1-3/8" drains, remove plastic bushing/adaptor from new Bath Shoe threads and apply pipe thread sealant onto metal outside threads of new Bath Shoe. For 1-1/2" drains, keep plastic bushing/adaptor on the new Bath Shoe threads.
10. Install new Tub Gasket between the drain and the tub.
11. Apply plumber's putty under the lip of the new Bath Shoe.
12. Install new Bath Shoe and tighten with bath shoe wrench until plumber's putty forms a seal.
13. Install Strainer by pushing firmly into drain opening and securing with screw through center hole. Tighten with screwdriver.

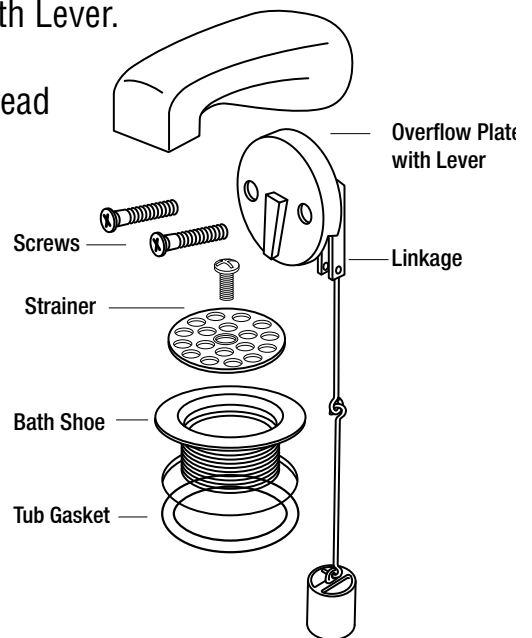
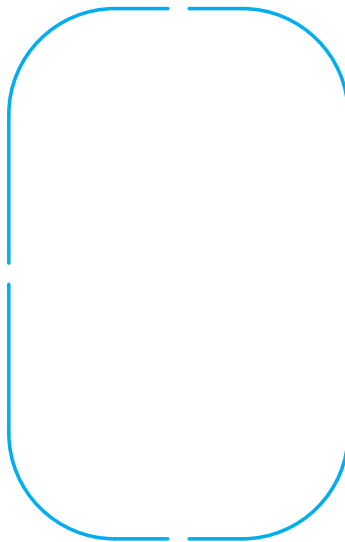

Tools needed for Installation:

Screwdriver • Bath Shoe Wrench • Pipe Thread Sealant • Plumber's Putty